

PROJECT	QUANTITY	ITEM NO
---------	----------	---------

# Bun warmer

## 6 trays X 3 shelves

MODEL **BW-6**



Model BW-6 three-shelf bun warmer with capacity for 6 pans per shelf.

### General Information

Henny Penny bun warmers help your sandwich stations achieve consistent quality and higher productivity. The BW-6 is a convection countertop cabinet with three shelves designed to maintain a maximum number of buns at optimal

temperature and texture while offering efficient access across workflow.

### Standard features

- Stainless steel shelves and cabinet.
- Narrow one-pan depth maximizes work flow access.
- Top mounted control box conserves counter space.
- Shelves accept standard bun trays.
- Electronic controlled heat from 140-200°F (60-93°C).
- Convection fan produces even heat.
- Scratch resistant acrylic sliding doors.
- Choice of left or right side power cord.

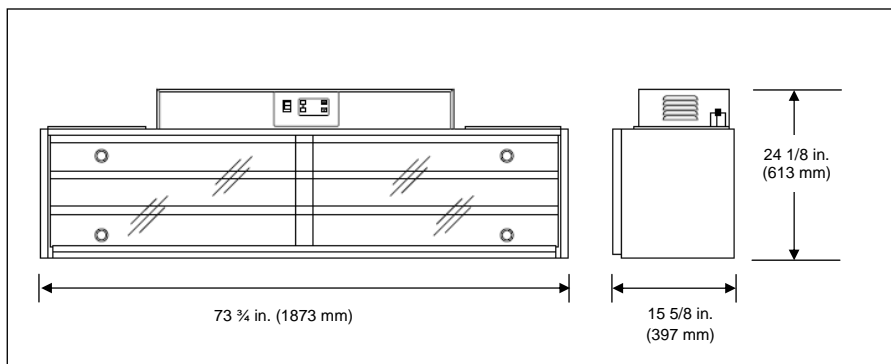

### Dimensions

Height: 24 1/8 in. (613 mm)  
Width: 73 3/4 in. (1873 mm)  
Depth: 15 5/8 in. (397 mm)

**Required clearances:** N/A

### Crated dimensions

Length: 77 in. (1956 mm)  
Depth: 21 1/2 in. (546 mm)  
Height: 32 in. (813 mm)  
Volume: 29.9 cu. ft. (0.84 m³)

**Crated weight** 229 lbs. (104 kg)

### Heating

Electric convection: 140-200°F (60-93°C)

### Tray capacity

18 standard bun trays 10 1/2 x 14 in. (267 x 366 mm), 6 per shelf X 3 shelves.

### Electrical

Volts	Phase	Cycle/Hz	Watts	Amps	Wire
120	1	50/60	1640	13.7	2+G
240	1	50/60	1800	7.5	2+G
230	1	50	1600	7.0	1NG

Please specify power cord location: ☐ right ☐ left.

### Laboratory certifications



### Bidding Specifications

- Provide Henny Penny bun warmer for consistent warming and quality and more efficient sandwich production.
- Model BW-6 features three shelves and six-pan capacity per shelf.
- Interior and exterior of units shall be constructed of stainless steel.
- Sliding doors shall be of scratch-resistant acrylic.
- Heating method is electric convection, with electronic controls for temperature range of 140-200°F (60-93°C).
- Accepts standard 10 1/2 x 14 in. (267 x 366 mm) bun pans, available separately.

☐ APPROVED ☐ APPROVED AS NOTED ☐ RESUBMIT

AUTHORIZED SIGNATURE

DATE

**HENNY PENNY**  
Global Foodservice Solutions

Henny Penny Corporation  
PO Box 60 Eaton OH 45320 USA

+1 937 456.8400 800 417.8417  
+1 937 456.8434 Fax 800 417.8434 Fax

[www.hennypenny.com](http://www.hennypenny.com)